



图1 梯田式花园庭院的正面图
Façade of Hilgard Garden

Hilgard Garden

梯田式的花园庭院

设计公司：玛丽·贝瑞斯菲尔德建筑公司 Architects: Mary Barenfeld Architecture
供稿及图片提供：玛丽·贝瑞斯菲尔德建筑公司
Text & Photograph Provided by Mary Barenfeld Architecture
摄影师：乔·弗莱彻 Photographer: Joe Fletcher
图文整理：CP Reorganizer: CP

图2 梯田式花园
庭院的侧面图
Side view of
Hilgard Garden



玛丽·贝瑞斯菲尔德建筑公司的新作梯田式花园庭院，位于加州伯克利大学的附近。

这个花园旨在拓展业主的户外生活空间。由于业主的院子有一个陡峭的坡，坡上坡下各有一块平坦的用地可作为休息场所。为了避免占用过多的庭院面积，设计师采用了高台地式布局，上面种上了日本枫树和芳香植物。业主希望将室外座椅区和娱乐区布置在靠近房屋的位置。

Hilgard Garden was a new project designed by Mary Barenfeld Architecture, which lies in near the University of California Berkeley.

Hilgard Garden aims to provide the owners with an extended outdoor living space, a garden room. Due to the steeply sloping site, accessibility to an upper seating area requires navigating a considerable elevation change. To avoid taking up a large swathe of the smaller backyard square footage with a conventional stair, a ramping meandering path through aromatic groundcover and the outstretched limbs of sculptural Japanese maples was selected as a more experiential garden path.

业主的房子是一栋建于1964年的联排别墅，这些别墅每4栋连成一行，其中每栋都有自己的私人庭院。别墅采用了雪松木瓦等材料，建筑颇有日式民居风格，其中室内装修则是现代简约风格。为此，庭院的设计也是简约风格，并采用了部分具有日式风韵的植物。白色的花岗岩露台，木地板，镜面水池，混凝土挡土墙，锈蚀钢板，日本枫树，百里香，匍匐珍妮蔷薇，竹子等是花园的主要材料/物件。其中的光影，水，材料的细部质感被优雅地体现。

图3 梯田式花园庭院一角
A corner of Hilgard Garden



The garden aims to use light and shadow, water reflection, material weathering and material texture as design elements.

庭院中的光影，水，材料的细部质感被优雅地体现。



图4 环绕木质地板的花园庭院
Hilgard Garden surrounding with wood floor

The townhouse was built in 1964 as part of a 4 unit building, with each unit having a private yard. The townhouse style uniquely combines a cedar shingled roofline with exterior walls reminiscent of traditional Japanese residences (flat white planes with natural wood border details). The home interior fits the owners' modernist aesthetic with clean sliding planes and abstract overhead light wells. Consideration was made to simplify building material and plant choices. The garden aims to use light and shadow, water reflection, material weathering and material texture as design elements. Ipe wood decking and benches, a floating white granite patio, a reflecting pool, board-form concrete retaining walls, and weathering steel combine with Japanese maples, aromatic lemon thyme, creeping jenny and Koi bamboo to form the garden's material palette.



图 5 夜晚光影下的花园庭院
The garden courtyard under the lights and shadows in the evening

图 6 梯田式花园庭院的平台上小憩
To have a rest on the platform of Hilgard Garden

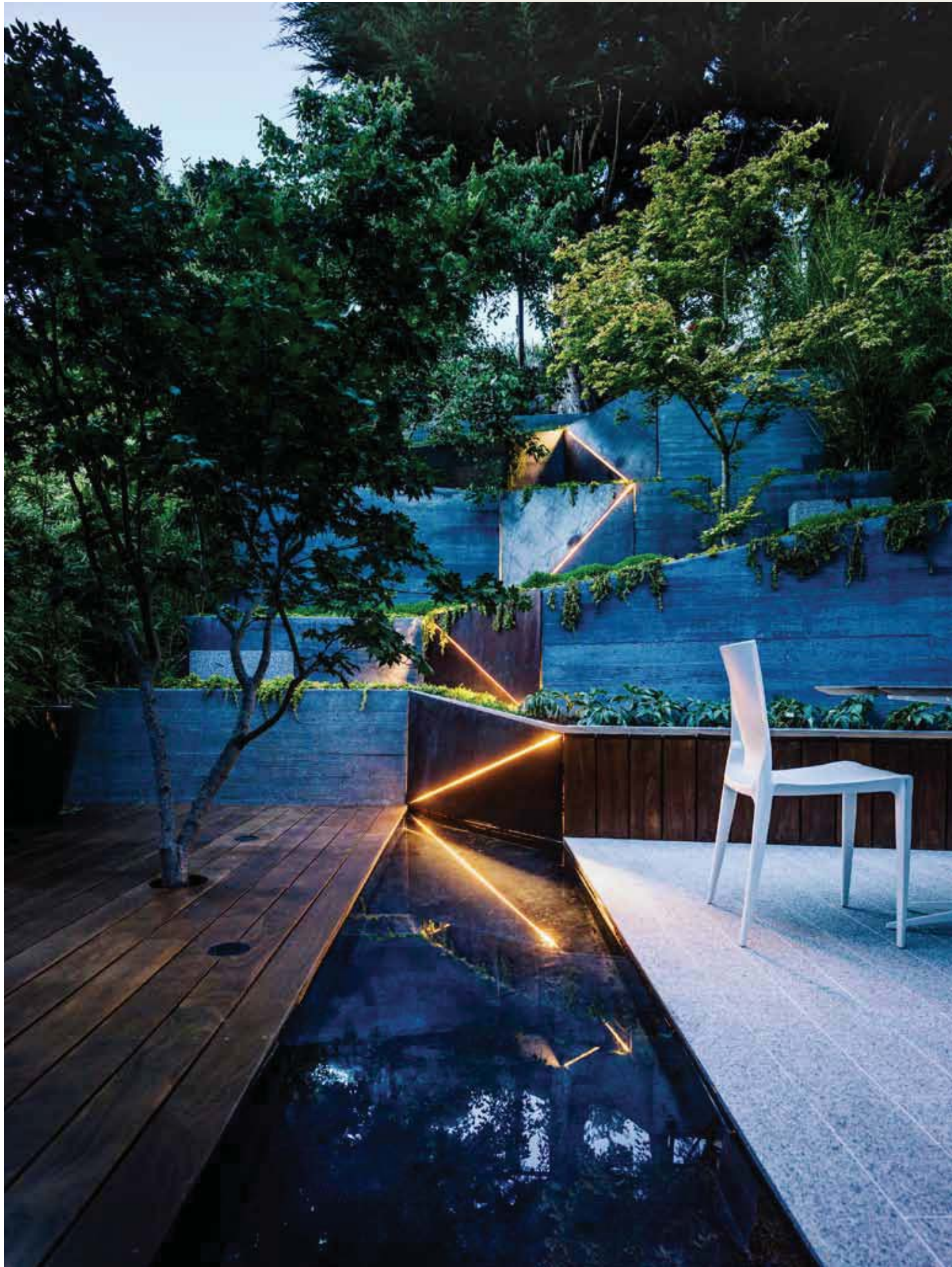

庭院 37m² 的户外活动空间是客厅的延伸,是一个“新”客厅。如镜的水池倒映着美丽的日本枫树,到了夜晚,藏在锈蚀钢板中的折线灯从坡下通往坡上。坡顶的平台可以欣赏到旧金山和东湾的美景。

The 400 square foot lower patio area, located at the base of the site and on the same level as the living room, provides the clients with a seamless extension of their living space for relaxation and entertaining. It aspires, in the classic modernist sense, to be the new living room of the townhouse. Upon entering the home, one's eye is drawn through the existing glass living room doors and out to the garden's water reflecting pool and 3 sculptural Japanese maples. At night, the back-lit triangular steel panels' LED lights further draws your attention out and upwards towards the 60 square foot upper terrace seating area and its views over the East Bay and San Francisco.

图 7 日本枫树, 百里香, 匍匐珍妮蔷薇, 竹子等是花园的主要材料
Japanese maples, aromatic lemon thyme, creeping jenny and Koi bamboo to form the garden's material palette





图 8 俯瞰花园庭院
Overlooking the garden courtyard

业主的女儿非常喜欢庭院中的竹子。两位业主中，一位是工程技术师，一位是平面设计师，他们都对建筑和设计感兴趣，他们被现代设计特别是使用混凝土的现代设计所震撼。这个现代简约的设计还推崇了可持续发展的理念，采用了中水灌溉系统。

The owners are Bay Area natives with a one year old daughter, who loves to look at the bamboo leaves. One owner works in technology, the other is a graphic designer. They've both been very interested in architecture and design since they first met 15 years ago and wanted to embrace the modern design found in Berkeley, especially the use of concrete to make a strong impact. Following the Bay Area philosophy to embrace more sustainable building practices, the garden incorporates a graywater drainage and irrigation system that the owners are currently working to hook into their home's graywater system.

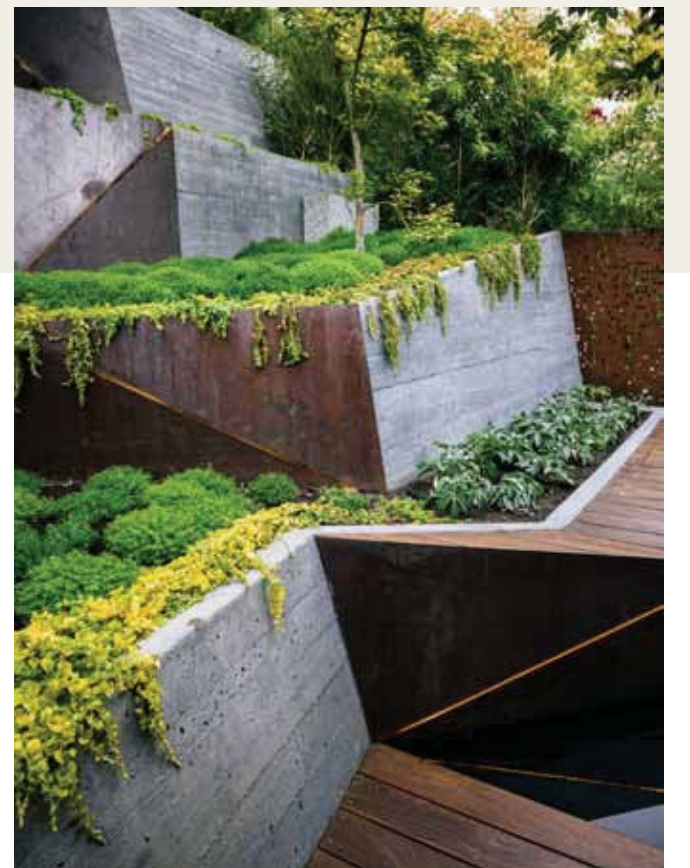
图 9 在庭院中起到装饰性作用的多孔铁皮墙
weathering multihole iron wall for decoration
in the garden courtyard



图 10 梯田式花园庭院的设计师手绘图
Hilgard Garden Sketch



图 11 梯田式花园庭院的设计图
Hilgard Garden blueprint

CHINA PENJING
& SCHOLAR'S ROCKS

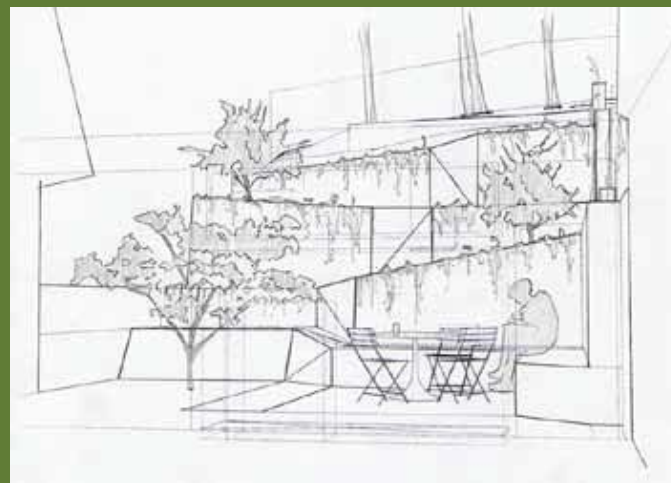
中国盆景赏石



主编：中国盆景艺术家协会

Edited by China Penjing Artists Association

盆景世界行——日本特辑

Penjing in the World—Special Issue of Japan





“春日峥嵘”雀梅 *Sageretia theezans* 高120cm 岭南盆景名家 吴成发、陈昌、黄就伟精品展 苏放摄影
“Being Remarkable in Spring” . Height: 120cm. Masterpieces' Exhibition of Lingnan Penjing
from Ng Shingfat, Chen Chang, Huang Jiuwe. Photographer: Su Fang



“云壑柏韵” 刺柏 *Juniperus formosana* Hayata 高 150cm 山东省第七届“鲁风”盆景精品展展品
王正生藏品 苏放摄影

“Clouds Sink and Cypress Charm”. Chinese juniper. Height: 150cm. Exhibit of 7th “Lu



“惊涛” 三角梅 *Bougainvillea spectabilis* 高 100cm 岭南盆景名家 吴成发、陈昌、黄就伟精品展 苏放摄影
“Great Wave”. Triangular Plum. Height: 100cm. Masterpieces' Exhibition of Lingnan Penjing
from Ng Shingfat, Chen Chang, Huang Jiuwei. Photographer: Su Fang



“紫霞萝锁木石盟” 三角梅附石 *Bougainvillea spectabilis* 高 120cm 岭南盆景名家
吴成发、陈昌、黄就伟精品展 苏放摄影

“The Blossoming of Purple Flowers When is as Close as Tree and Stone”. Triangular Plum.
Height:120cm. Masterpieces' Exhibition of Lingnan Penjing from Ng Shingfat, Chen Chang,
Huang Jiuwei. Photographer: Su Fang



“岱岳雄风” 侧柏 *Platycladus orientalis* (L.) Franco 高 120cm 山东省第七届“鲁风”盆景精品展金奖
陈广君藏品 苏放摄影

“Daiyue Glory”. Chinese Arbor-vitae. Height: 120cm. The Gold Prize of 7th “Lu Feng”
Penjing Masterpieces’ Exhibition of Shandong Province. Collector: Chen Guangjun,
Photographer: Su Fang